

1 Shepherd's House Manor Park Road
Chislehurst, BR7 5FT
T: 0208 304 0997
E: property@tracythorne-estates.co.uk



**77 Jackson Road, Bromley
BR2 8NT**

Asking price £550,000

This extended stunning two double bedroom semi-detached house is situated on Jackson Road, which is a popular location within Bromley Common. The property has been beautifully updated by the current owners and really needs to be viewed in order to appreciate its presentation, accommodation and location. It is close to local schools including Ravenswood for boys, with Darrick Wood junior and senior schools being a short bus ride away. Transport routes from the A21, lead to Bromley South and Orpington mainline stations.

Comprising porch, main reception/family room, superb extended kitchen/dining room leading to the downstairs utility/cloakroom/wc and with bi-folding doors opening onto the landscaped lawned and decked rear garden. Upstairs is the master bedroom, second double bedroom and beautiful modern fully tiled family bathroom with integrated shower.

The kitchen/dining room offers plenty of porcelain worktop space, a porcelain centre island with extra storage cupboards below and the downstairs cloakroom has a utility lobby space. Additional benefits include double glazing, gas central heating and no chain.





GROUND FLOOR
439 sq.ft. (40.7 sq.m.) approx.

1ST FLOOR
334 sq.ft. (31.0 sq.m.) approx.

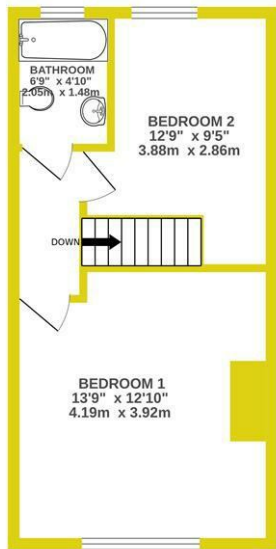
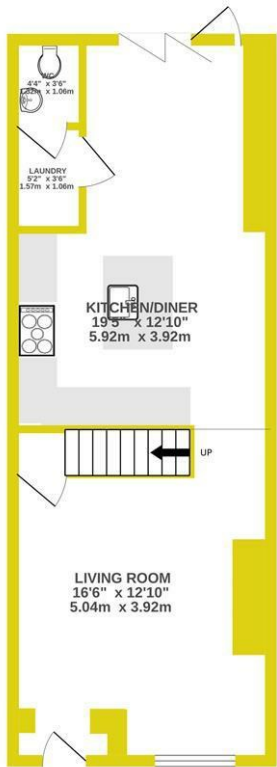

TOTAL FLOOR AREA: 772 sq.ft. (71.7 sq.m.) approx.

Whilst every attempt has been made to ensure the accuracy of the floorplan contained here, measurements of doors, windows, rooms and any other items are approximate and no responsibility is taken for any error, omission or mis-statement. This plan is for illustrative purposes only and should be used as such by any prospective purchaser. The services, systems and appliances shown have not been tested and no guarantee as to their operability or efficiency can be given.

Made with Memento 12/2025

